

PLAT OF SURVEY

- OF -

J.K. SURVEYING INC.
N3705 WILLOWBEND LANE
LAKE GENEVA, WI, 53147
262-248-3697

UNITS 305 AND 306 OF GENEVA TOWERS CONDOMINIUM (WEST TOWER)
LOCATED AT 101 BROAD STREET, LAKE GENEVA, WISCONSIN. AS IT IS SHOWN ON PARCEL
" A " TOGETHER WITH OTHER PARCELS AND EASEMENTS AS DEFINED IN THE CONDOMINIUM
OWNERSHIP DECLARATIONS, AND THE PLAT DEFINED AS EXHIBIT " A " .

PARCEL A: THAT PART OF SECTION 36, TOWN 1 NORTH, RANGE 17 EAST
OF THE FOURTH PRINCIPAL MERIDIAN, IN BLOCK 30 OF THE ORIGINAL PLAT OF THE CITY
OF LAKE GENEVA, DISCRIBES AS FOLLOWS:

BEGINING AT THE NORTHWEST CORNER OF SAID BLOCK 30; THENCE SOUTH
183.35 FEET; THENCE SOUTH 18 DEGREES 34 MINUTES EAST, 90.83 FEET;
THENCE SOUTH 28 DEGREES 40 MINUTES EAST, 204 FEET; THENCE NORTH 61
DEGREES 40 MINUTES EAST, 9.42 FEET; THENCE NORTH 81 DEGREES 02 MINUTES
EAST, 49.84 FEET; THENCE NORTH 72 DEGREES 02 MINUTES EAST, 16.57 FEET;
THENCE NORTH 60 DEGREES 25 MINUTES EAST, 88.64 FEET; THENCE NORTH 62
DEGREES 24 MINUTES EAST, 12.55 FEET; THENCE NORTH 00 DEGREES 06
MINUTES WEST, 203.19 FEET; THENCE NORTH 89 DEGREES 48 MINUTES WEST,
190.85 FEET, TO THE POINT OF BEGINNING, IN THE CITY OF LAKE GENEVA, WALWORTH
COUNTY, WISCONSIN.

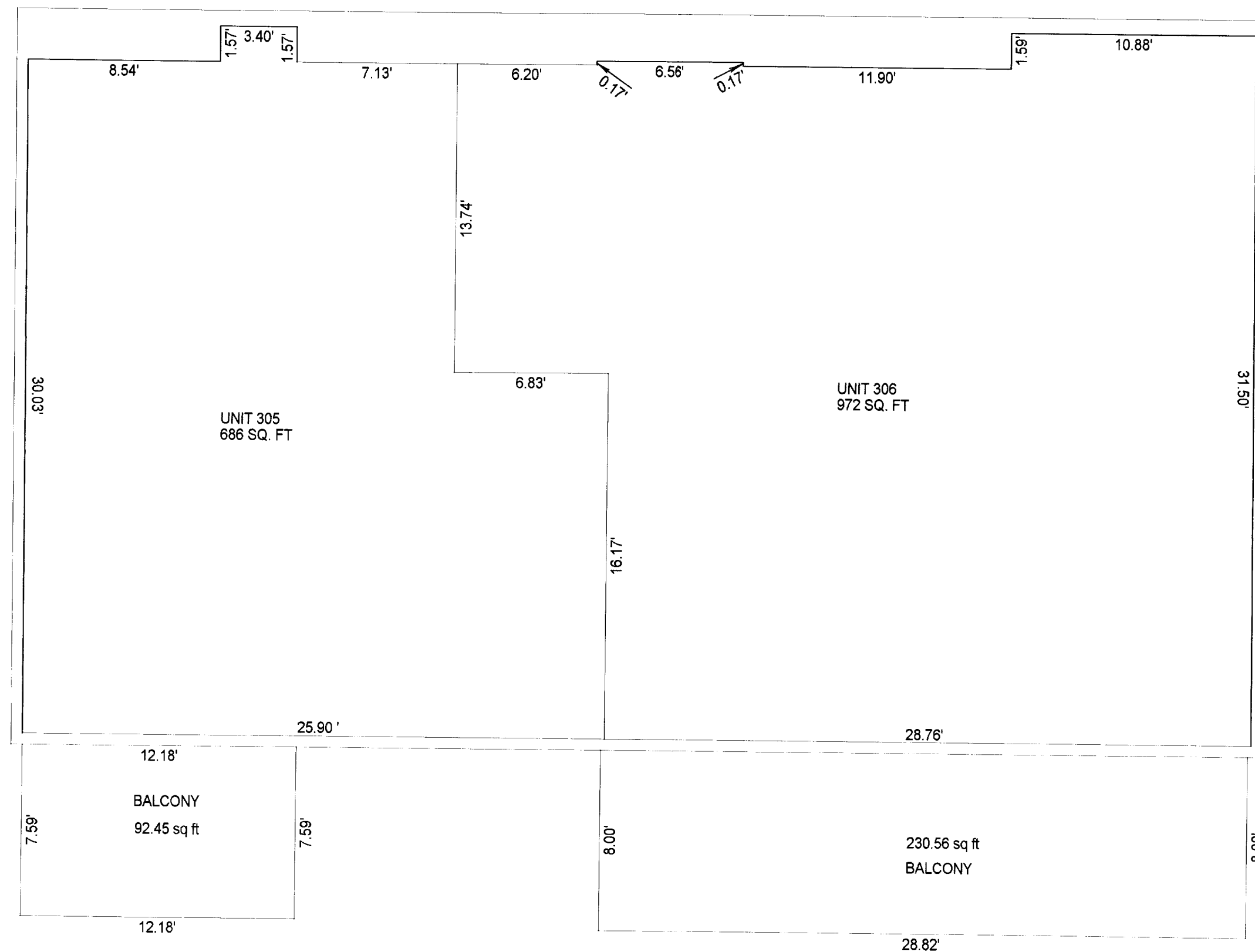

COMPARE LEGAL DESCRIPTION ABOVE AND DRAWING WITH DEED, FOR BUILDING RESTRICTIONS AND
EASEMENTS NOT SHOWN, REFER TO DEED, ABSTRACT SOURCES AND LOCAL MUNICIPAL CODES. NOTIFY
THE SURVEYOR IMMEDIATELY OF ANY DISCREPANCY.

"I hereby certify that I have surveyed the above described property and that
the above map is a true representation thereof and shows the size and
location of all visible structures, apparent easements and encroachments
if any."
This survey is made for the present owners of the property, and those who
purchase, mortgage, or guarantee the title thereto, within one year from
the date hereof.

DATED THIS 25 TH, DAY OF SEPT 20 03

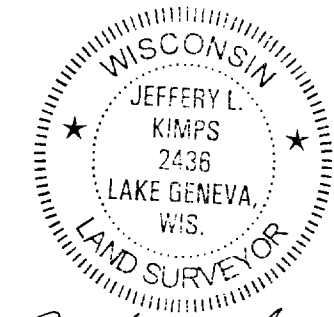

JEFFREY L. KIMPS S - 2436
Wisconsin Registered Land Surveyor
(original if signed in red)

007-2134